

.034 Coaxial Cable – 50 Ω Semi-Rigid Tin-Plated Copper



© 2024 EZ FORM CABLE INC. ALL RIGHTS RESERVED.

EZ-34-TP

∅.034" Semi-Rigid Tin-Plated Copper Outer Conductor,
SPCW Center Conductor, PTFE Dielectric, 50 Ω.

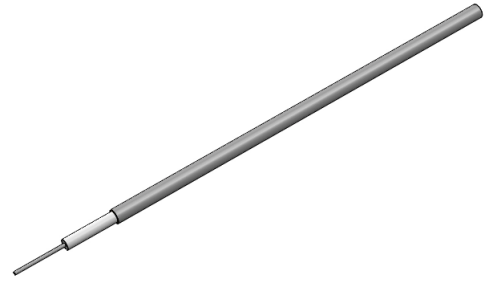

Specifications

DIMENSIONS

Center Conductor Diameter	0.0080 in
Dielectric Diameter	0.0260 in
Outer Conductor Diameter	0.0340 in

MATERIALS

Center Conductor Material	SPCW
Dielectric Material	PTFE
Outer Conductor Material	Copper
Outer Conductor Plating Material	Tin
RoHS Compliant	Yes

MECHANICAL CHARACTERISTICS

Minimum Temperature	-55 °C
Maximum Temperature	+100 °C
Inside Bend Radius (Minimum)	0.050 in
Weight	0.22 lbs per 100 ft

ELECTRICAL CHARACTERISTICS

Nominal Impedance	50.0 Ω
Nominal Impedance Margin	±3.0 Ω
Velocity of Propagation	69.50%
Shielding Effectiveness	>165 db
Voltage Withstanding	2000 VRMS @ 60 Hz
Continuous Working Voltage	750 VRMS max
Maximum Operating Frequency	153 GHz

Attenuation

FREQUENCY	DB / 100 FT TYPICAL
0.5 GHz	33.5 db
1.0 GHz	47.5 db
5.0 GHz	110 db
10.0 GHz	159 db
18.0 GHz	225 db
26.5 GHz	265 db
40.0 GHz	333 db
50.0 GHz	377 db
65.0 GHz	437 db
90.0 GHz	525 db

Power

FREQUENCY	WATTS CW @ 20 °C (MAX)
0.5 GHz	35 W
1.0 GHz	25 W
5.0 GHz	11 W
10.0 GHz	8 W
18.0 GHz	6 W
26.5 GHz	5 W
40.0 GHz	3.7 W
50.0 GHz	3.3 W
65.0 GHz	2.8 W
90.0 GHz	2.4 W