

.034 Coaxial Cable – 50 Ω Semi-Rigid Stainless Steel with S.S. Center Conductor



© 2024 EZ FORM CABLE INC. ALL RIGHTS RESERVED.

EZ-34-SS-SS

ø.034" Semi-Rigid Stainless Steel Outer Conductor, SS
Center Conductor, PTFE Dielectric, 50 Ω.

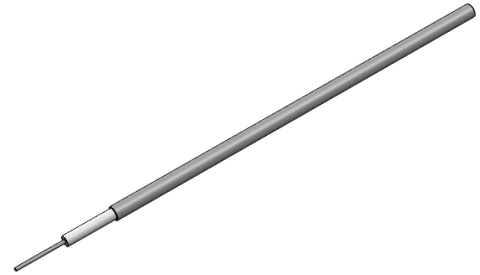

Specifications

DIMENSIONS

Center Conductor Diameter	0.0080 in
Dielectric Diameter	0.0260 in
Outer Conductor Diameter	0.0340 in

MATERIALS

Center Conductor Material	SS
Dielectric Material	PTFE
Outer Conductor Material	Stainless Steel
RoHS Compliant	Yes

MECHANICAL CHARACTERISTICS

Minimum Temperature	-55 °C
Maximum Temperature	+175 °C
Inside Bend Radius (Minimum)	0.250 in
Weight	0.21 lbs per 100 ft

ELECTRICAL CHARACTERISTICS

Nominal Impedance	50.0 Ω
Nominal Impedance Margin	±3.0 Ω
Velocity of Propagation	69.50%
Shielding Effectiveness	>165 db
Voltage Withstanding	2000 VRMS @ 60 Hz
Continuous Working Voltage	800 VRMS max
Maximum Operating Frequency	153 GHz

Attenuation

FREQUENCY	DB / 100 FT TYPICAL
0.5 GHz	225 db
1.0 GHz	320 db
5.0 GHz	715 db
10.0 GHz	1000 db
18.0 GHz	1350 db
26.5 GHz	1650 db
40.0 GHz	2040 db
50.0 GHz	2290 db
65.0 GHz	2620 db
90.0 GHz	3090 db

Power

FREQUENCY	WATTS CW @ 20 °C (MAX)
0.5 GHz	8 W
1.0 GHz	6 W
5.0 GHz	2.5 W
10.0 GHz	1.8 W
18.0 GHz	1.4 W
26.5 GHz	1.1 W
40.0 GHz	0.9 W
50.0 GHz	0.8 W
65.0 GHz	0.7 W
90.0 GHz	0.6 W